

PSE 100 PK

Pneumatic Vacuum Switch



The PSE 100 K vacuum switch with pneumatic output is used to check the vacuum level in the circuit.

It is recommended for measuring slowly changing vacuum levels such as regulating or checking vacuum levels in networks over 1 liter.

This vacuum switch exists in two versions: NO version recommended for the "air saving" function on a venturi and NC version for the "safety" function (object detected, etc.) and "SFC signal".

Industry-specific applications

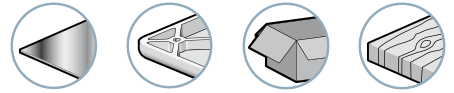

Specifications

Models	Two versions: NO and NC
Compatible fluids	All non-corrosive, non-lubricated gases
Operating pressure	2 to 6 bar
Adjustment range	NF: -250 to -830 mb, NO: -350 to -880 mb
Precision	± 10 %
Hysteresis	NF: 10 mb - NO: 200 mb
Repetitivity	< 3% of the whole range
Maximum speed	30 cycles per minute
Permissible overpressure	2 bar (destructive at 5 bar) (on vacuum measuring orifice)
Mechanical endurance	5 x 10 ⁶ operations
Materials	Body: Polyacetal - Vacuum sensor: nitrile membrane
Weight	32 g
Temperature	-10 °C to 80 °C / 14 °F to 176 °F
Flow rate at 6 bar	66 NI/min

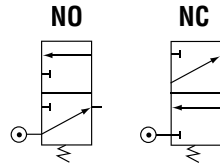

Dimensions

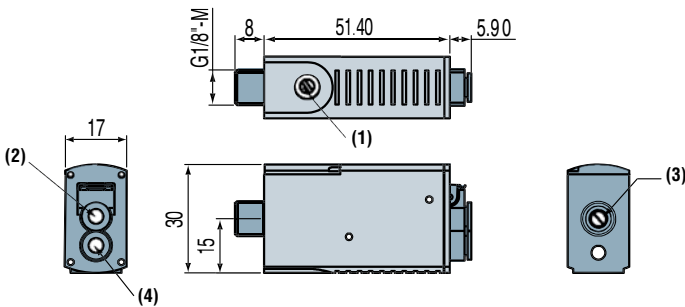

(1) Vacuum threshold adjustment
(2) Signal output, NC or NO tube

(3) M5 Vacuum input
(4) Pressure input Ø4 tube

Additional Information

- Mounting in GVO option in the GVP / GEMP vacuum pump range.

Pneumatic connection

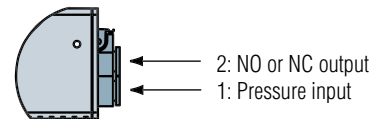

Vacuum switch attachment - Clip Part No: PSE.F

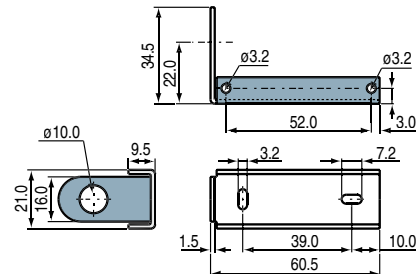

Note: all dimensions shown in (mm)

For all orders, please specify:
Model + Version.
Example: PSE100PKNO

1: Model	2: Version
PSE 100 PK	NO Normally Open (NO)
	NF Normally Closed (NC)